

## Welch Allyn 4400 and MS3 Mobile Stand Assembly instructions

REF 777102, 80030768 Ver. A  
Revision date: 2024-05

**baxter.com**  
Baxter Technical Support: [baxter.com/contact-us](https://baxter.com/contact-us)  
Baxter and Welch Allyn are trademarks of  
Baxter International Inc. or its subsidiaries.



(91)777102

REF 4400-MBS & 7000-MS3

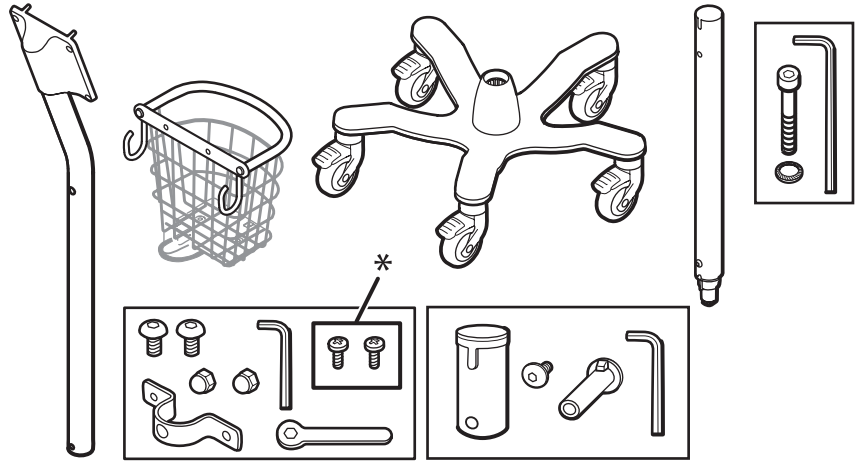

1

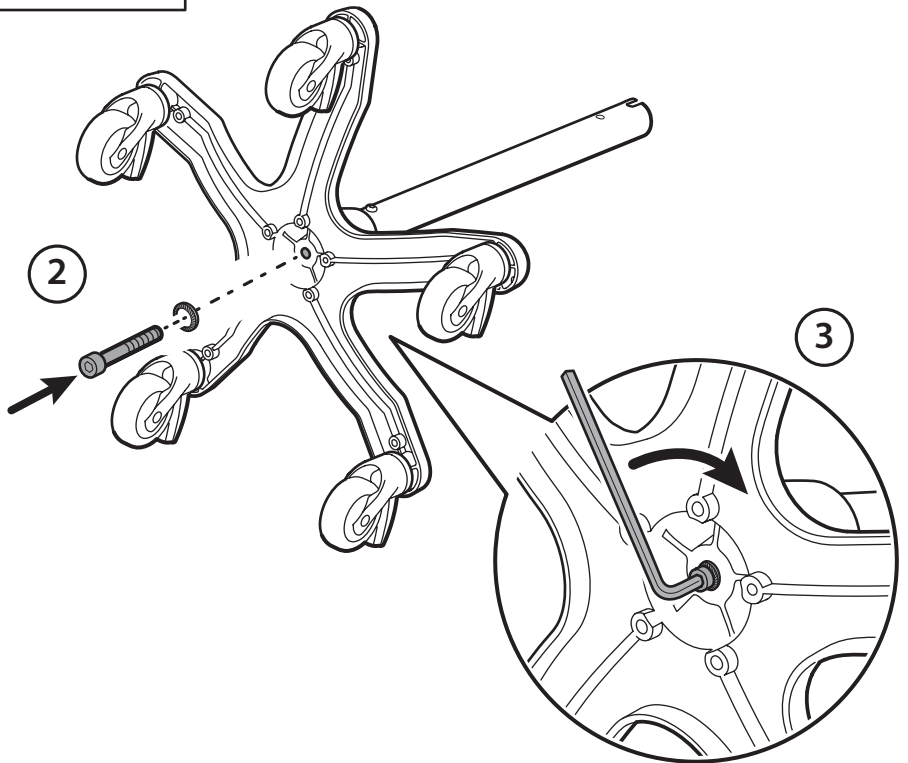
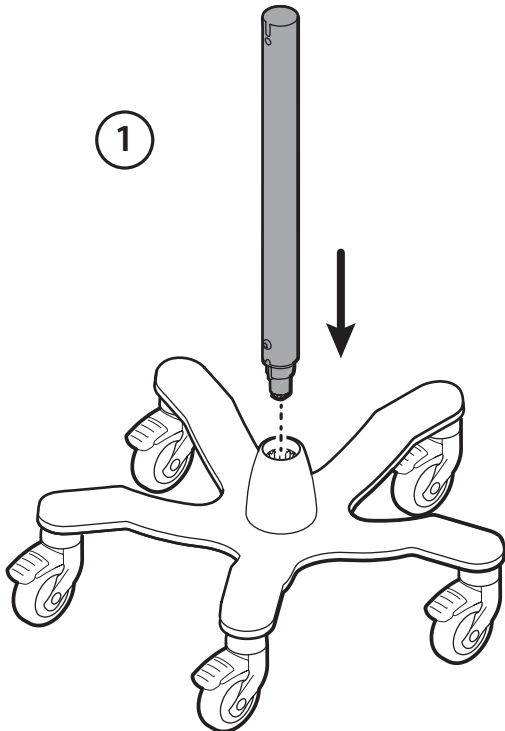
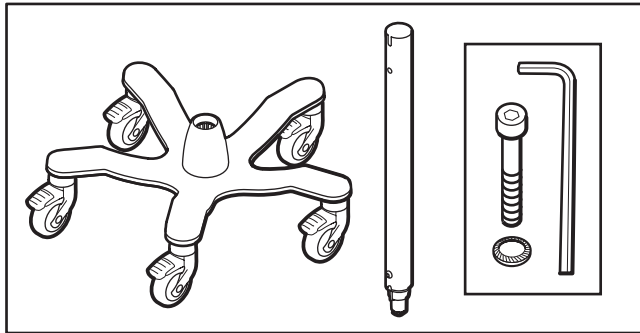

80+/-10 in-lb. (9.04+/-1.13 Nm)



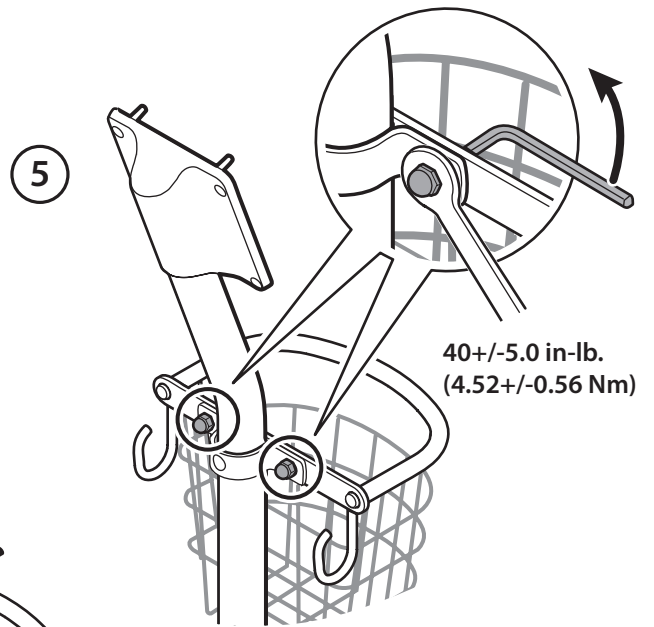
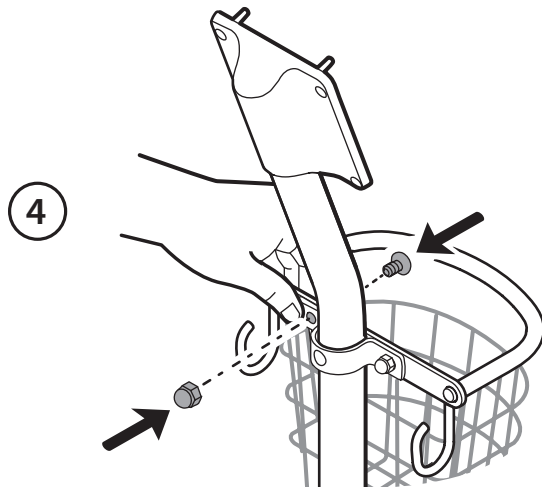
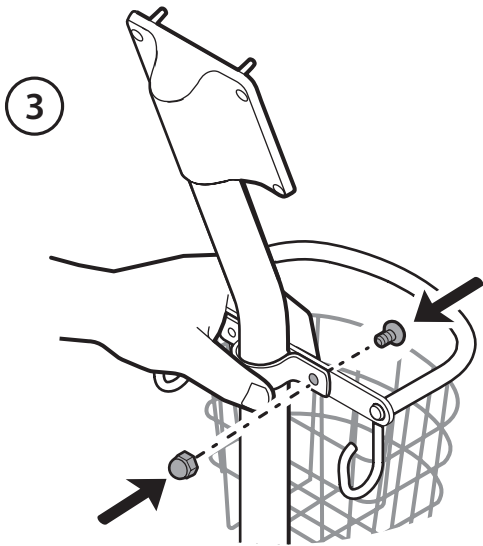
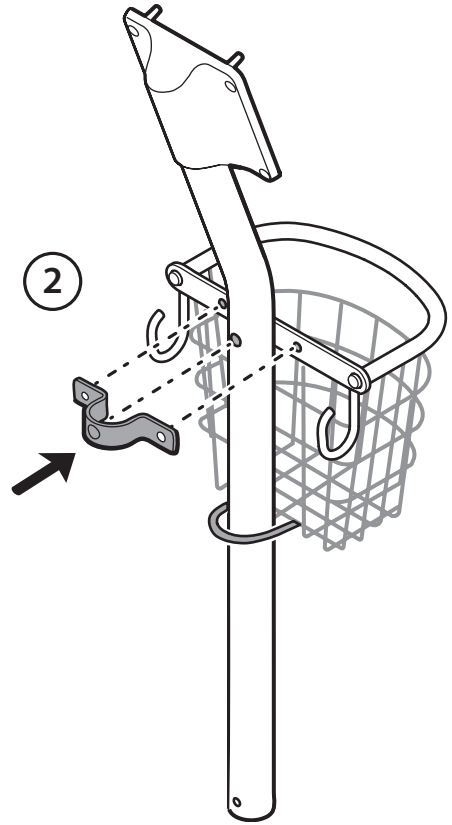
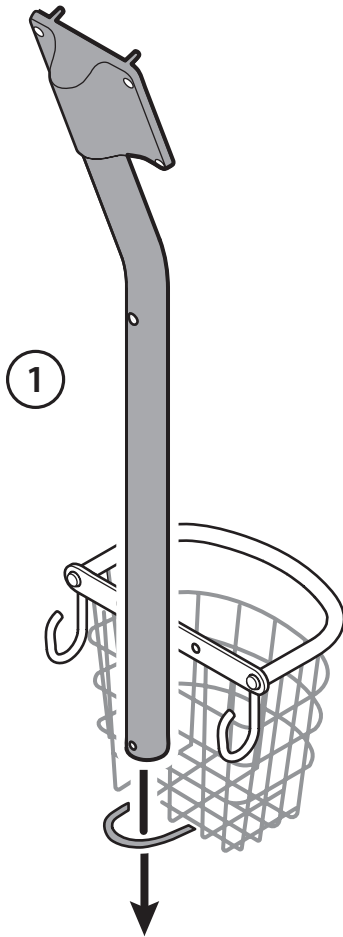
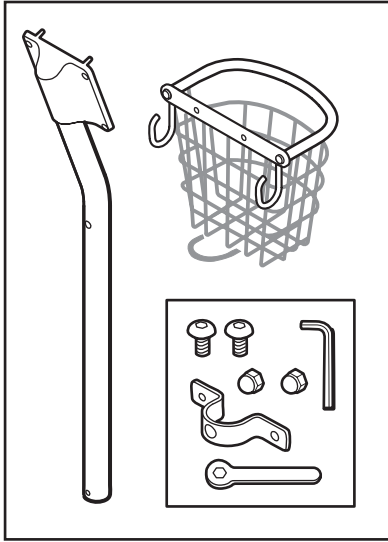

3

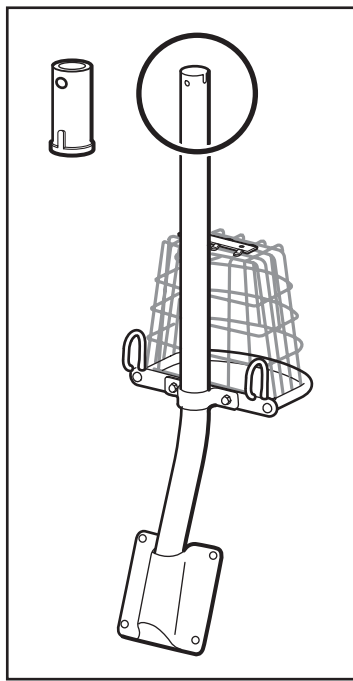

1

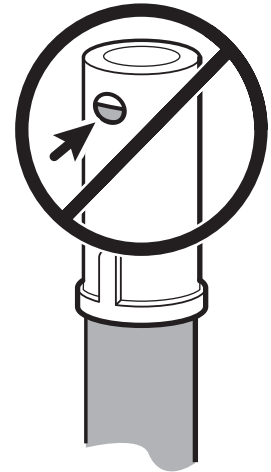
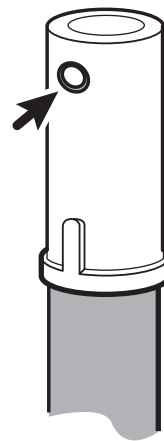
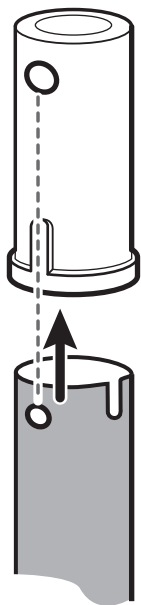

4

1

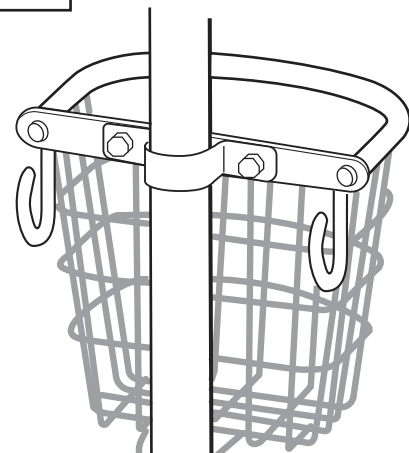
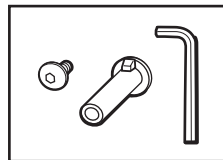
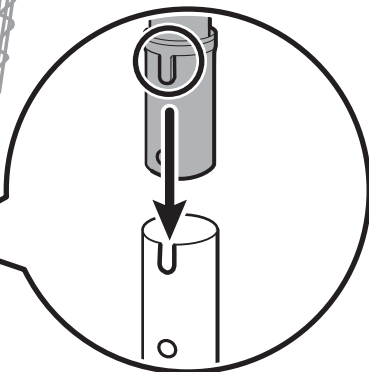
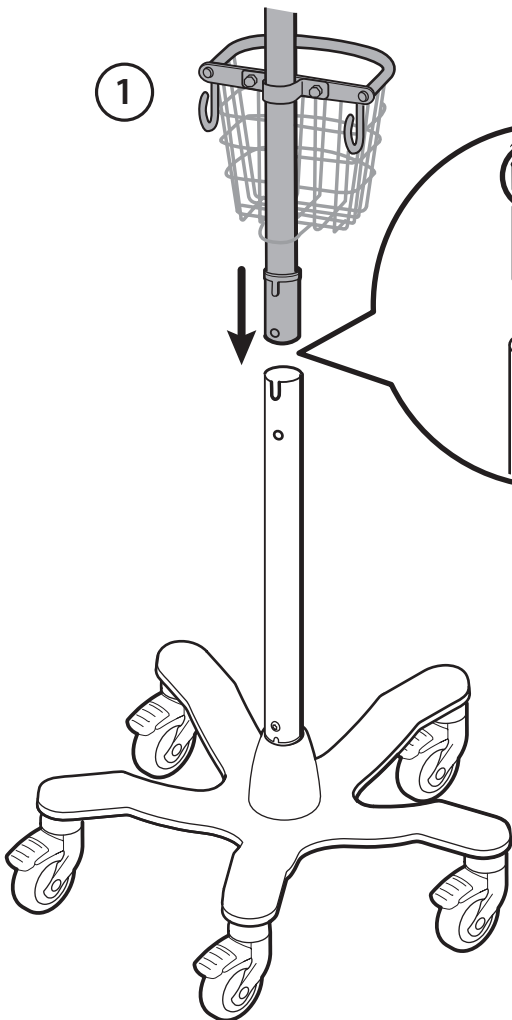

2

3

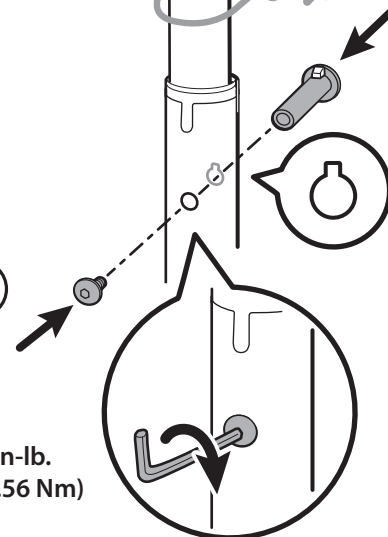

40+/-5.0 in-lb.  
(4.52+/-0.56 Nm)



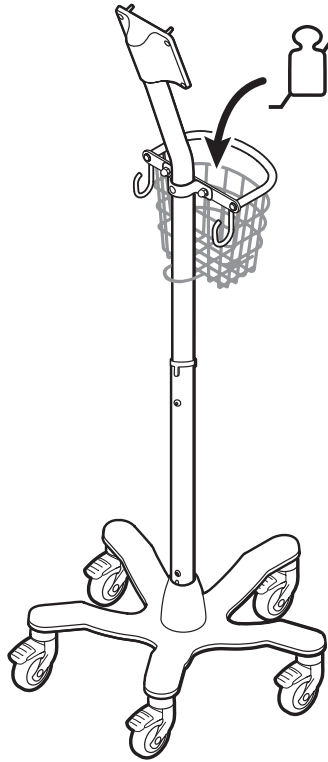

- Maximum safe working load limits. (EN)
- 最大安全工作负载限制 (CN)
- 最大安全工作負荷限制 (TW)
- Ograničenja maksimalnog sigurnog radnog opterećenja. (HR)
- Maximální limity bezpečné pracovní zátěže. (CS)
- Maksimale grænser for sikker arbejdsbelastning. (DA)
- Bovengrens voor veilige werkbelasting. (NL)
- Turvallisen ty skentelyn enimm iskuormitusrajat. (FI)
- Charge de travail de sécurité maximale. (FR)
- Maximale sichere Tragfähigkeit. (DE)
- Όρια μέγιστου ασφαλούς φορτίου εργασίας. (EL)
- Maximális biztonságos üzemi terhelés határértékei. (HU)
- Limiti del carico di lavoro massimo in sicurezza. (IT)
- Ең қауіпсіз жұмыс жүктемесінің шектері. (KK)
- 안전 사용 하중 최대 한계. (KO)
- Maksimālās drošas darba slodzes ierobežojumi. (LV)
- Maksimumsgrenser for sikker arbeidslast. (NO)
- Limity maksymalnego bezpiecznego obciążenia roboczego. (PL)
- Carga máxima de segurança. (BR)
- Limites de segurança máximos da carga de trabalho. (PT)
- Limite pentru sarcina maximă sigură de lucru. (RO)
- Максимально безопасные пределы рабочей нагрузки (RU)
- Granice maksimalnog bezbednog radnog opterećenja. (SR)
- Najvišje varne delovne obremenitve. (SL)
- Carga de trabajo segura máxima. (ES)
- Maximala arbetsbelastning gränser för bästa säkerhet. (SV)
- ชีตจำกัดปริมาณงานที่ปลอดภัยสูงสุด (TH)
- Maksimum güvenli alıştırma yükü limitleri. (TR)

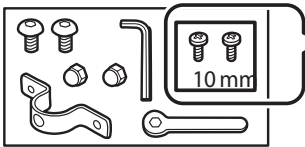

\* Save these screws to attach the power supply provided with the device. (EN)

保存这些螺钉以连接设备随附的电源。(CN)

保留這些螺絲，以用於連接裝置隨附的電源供應器。(TW)

Sačuvajte ove vijke za potrebe pričvršćivanja napajanja priloženog uz uređaj. (HR)

Uložte si tyto šrouby pro připevnění zdroje napájení dodaného s přístrojem. (CS)

Gem disse skruer for at tilslutte den strømforsyning, der fulgte med enheden. (DA)

Bewaar deze schroeven om de voedingseenheid te bevestigen die bij het apparaat is geleverd. (NL)

Säilytä ruuvit laitteen mukana toimitetun virtalähteen kiinnittämistä varten. (FI)

Conserver ces vis pour fixer le bloc d'alimentation électrique fourni à l'appareil. (FR)

Bewahren Sie die Schrauben zum Befestigen des Netzteils auf, das mit dem Gerät geliefert wird. (DE)

Φυλάξτε αυτές τις βίδες για να συνδέσετε το τροφοδοτικό που παρέχεται με τη συσκευή. (EL)

Őrizzze meg ezeket a csavarokat az eszközhöz biztosított tápegység rögzítéséhez. (HU)

Conservare queste viti per collegare l'alimentatore fornito con il dispositivo. (IT)

Құрылғымен бірге берілген қуат көзін бекіту үшін осы бұрандаларды сақтап қойыңыз. (KK)

이 나사를 보관하여 장치와 함께 제공된 전원 공급 장치를 연결합니다. (KO)

Saglabājiet šīs skrūves, lai pievienotu ierīces komplektācijā iekļauto barošanas avotu. (LV)

Ta vare på disse skruene for å feste strømforsyningen som følger med enheten. (NO)

Zachować te wkręty na potrzeby mocowania zasilacza dostarczonego z urządzeniem. (PL)

Guarde estes parafusos para fixar a fonte de alimentação fornecida com o dispositivo. (BR)

Guarde estes parafusos para fixar a fonte de alimentação fornecida com o dispositivo. (PT)

Păstrați aceste șuruburi pentru a atașa sursa de alimentare furnizată împreună cu dispozitivul. (RO)

Сохраните эти винты для подсоединения блока питания, входящего в комплект поставки устройства. (RU)

Sačuvajte ove vijke da biste priključili napajanje isporučeno uz uređaj. (SR)

Shranite te vijake, da boste lahko pritrdili napajalni kabel, dobavljen z napravo. (SL)

Guarde estos tornillos para fijar la fuente de alimentación suministrada con el dispositivo. (ES)

Spara skruvarna för att sätta fast strömförsörjningsenheten som medföljer enheten. (SV)

เก็บสกรูเหล่านี้ไว้เพื่อต่อแหล่งจ่ายไฟที่นำมาพร้อมกับอุปกรณ์ (TH)

Cihazla birlikte verilen güç kaynağını takmak için bu vidaları saklayın. (TR)

REF 411626

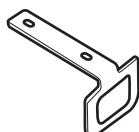
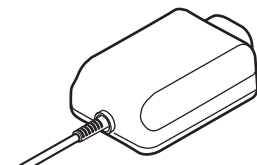

REF 411626

